

Tools Required:

- 3mm hex key
- 4mm hex key
- Phillips medium screwdriver



Dimensions

- A:** 8-5/8"
- B:** 6-3/4"



Protection Class: IP65

Weight: 6.6 lbs.

Notice to Installer for 66 983:

1. **BEGA luminaires may be damaged if connected to conduit systems containing water- Article 300-5G of National Electric Code requires that "Conduits or raceways through which moisture may contact energized live parts shall be sealed or plugged at either or both ends".**
2. Mounts directly to a standard octagonal 4" wiring box (by others) using adaptor plate (supplied).
3. In conformance with U.L. Standards 1598, a silicone-based sealant **MUST** be used between the mounting plate edge and supporting wall.
4. LEDs are high-quality electronic components! Please avoid touching the light output opening of the LED directly during installation.

Figure 1 - Generic Image

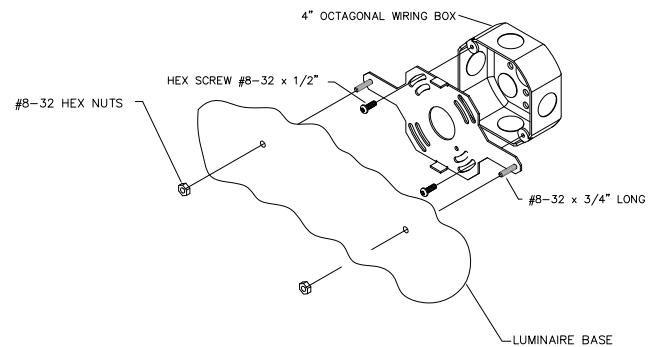

66 983 - installation:

1. Twist counter-clockwise and remove lens and reflector.
2. Install (2) long 8-32 x 3/4" mounting screws (provided) in the back of the adapter plate as shown.
3. Attach mounting plate to wiring box using (2) 8-32 x 1/2" screws provided. Feed luminaire wires through luminaire base and mounting plate.
4. Make supply wiring and luminaire wiring connections inside the wiring box:
 CONNECT WHITE (common) SUPPLY WIRE TO WHITE FIXTURE LEAD
 CONNECT BLACK (hot) SUPPLY WIRE TO BLACK FIXTURE LEAD
 CONNECT GREEN (ground) SUPPLY WIRE TO GREEN FIXTURE LEAD
- Dimming (if applicable):**
 DIMMING CONTROL WIRE (+) TO POSITIVE DRIVER DIM CONTROL WIRE
 DIMMING CONTROL WIRE (-) TO NEGATIVE DRIVER DIM CONTROL WIRE
6. Place a small bead of silicone around the back side of the luminaire base that will come in contact with the finished wall (exterior applications only).
7. Attach luminaire to mounting plate over the mounting screws using the (2) 8-32 hex nuts provided. Tighten the nuts to back the screws into the wiring box and secure the plate to the box.
8. Screw lens onto housing carefully, making sure the gasket is sealed properly.

Relamping/Maintenance

No relamping necessary.

Accessories

Please refer to the appropriate accessory installation sheet for further instruction when applicable.

Replacement Parts

Description	Part No
Diffuser	141083
LED driver (120V-277V)	75985-01
LED replacement (3000K)	LED-0441/930
LED replacement (4000K)	LED-0441/940

Lamp: 35.7W LED

In the interest of product improvement, BEGA reserves the right to make technical changes without notice.

Product Safety Warnings:

THIS PRODUCT MUST BE INSTALLED IN ACCORDANCE WITH THE APPLICABLE INSTALLATION CODE BY A PERSON FAMILIAR WITH THE CONSTRUCTION AND OPERATION OF THE PRODUCT AND THE HAZARDS INVOLVED. SUITABLE FOR WET LOCATIONS.

MIN 90°C SUPPLY CONDUCTORS.

CE PRODUIT DOIT ÊTRE INSTALLÉ SELON LE CODE D'INSTALLATION PERTINENT, PAR UNE PERSONNE QUI CONNAÎT BIEN LE PRODUIT ET SON FONCTIONNEMENT AINSI QUE LES RISQUES INHÉRENTS. CONVIENT AUX EMPLACEMENTS MOUILLÉS.

LES FILS D'ALIMENTATION 90°C MIN.
