

Tools Required:

- 3mm hex key
- Flat head screw driver medium
- Phillips head screw driver medium



Dimensions

- A: 3-3/4"
- B: 3-1/2"



Protection Class: IP65

Weight: 1.3 lbs.

Notice to Installer for 66 974:

1. **BEGA luminaires may be damaged if connected to conduit systems containing water- Article 300-5G of National Electric Code requires that "Conduits or raceways through which moisture may contact energized live parts shall be sealed or plugged at either or both ends".**
2. For attachment to ceiling surface, fixture mounts directly to 19 538 small opening wiring box (provided).
3. In conformance with U.L. Standards 1598, a silicone-based sealant **MUST** be used between the mounting plate edge and supporting wall.
4. LEDs are high-quality electronic components! Please avoid touching the light output opening of the LED directly during installation.
5. See installation sheet 99068, supplied, for detailed instructions on 19 538 small wiring box installation.

66 974 - installation:

1. Remove trim ring by turning counter-clockwise.
2. Undo quick disconnect from LED wires and driver wires.
3. Remove adapter plate assembly from luminaire base by unscrewing (2) hex head nuts on interior of main fixture casting.
5. Reattach quick disconnect between LED and driver wires.

NOTE: Make sure LED wires are routed through adapter plate before connecting.

6. Make supply wiring and LED driver connections in 19 538 small opening wiring box:

MAIN VOLTAGE SUPPLY WIRE TO BLACK LED DRIVER WIRE
 NEUTRAL (COMMON) SUPPLY WIRE TO WHITE LED DRIVER WIRE
 GREEN GROUND WIRE TO GREEN LUMINAIRE WIRE

Dimming (if applicable):

DIMMING CONTROL WIRE (+) TO POSITIVE DRIVER DIM CONTROL WIRE
 DIMMING CONTROL WIRE (-) TO NEGATIVE DRIVER DIM CONTROL WIRE

7. Place a small bead of silicone around the back side of the adapter plate assembly that will come in contact with the finished surface (exterior applications only), then attach adapter plate assembly to 19 538 wiring box using (2) 1/2" counter-sunk screws.
8. Place a small bead of silicone around the back side of the luminaire base that will come in contact with the adapter plate assembly (exterior applications only), then re-attach adapter plate assembly to luminaire base using (2) hex head nuts and studs.
9. Replace luminaire trim ring and lens, making sure the gasket is sealed properly.

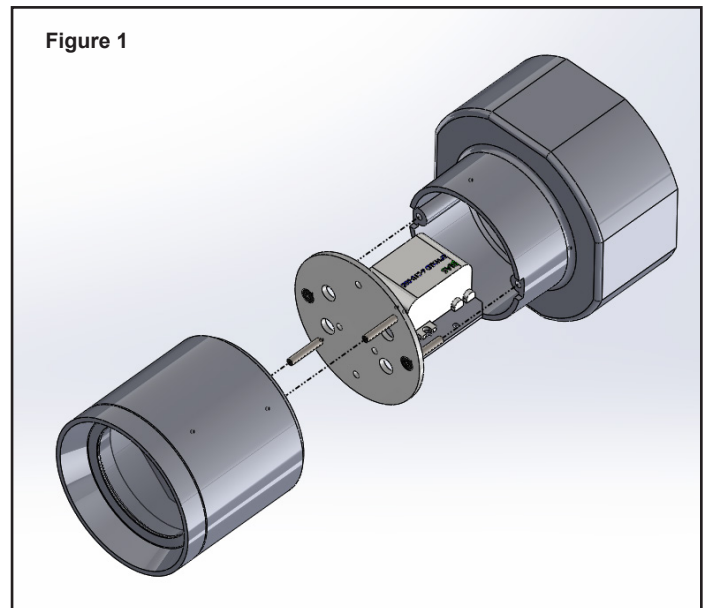
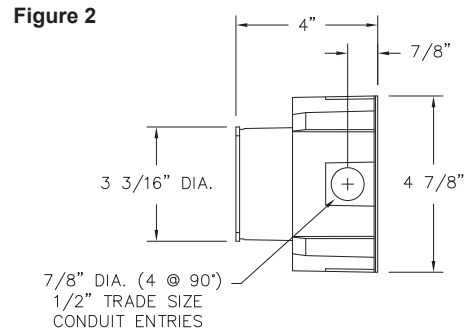

Figure 1



Relamping/Maintenance

No relamping required.

Accessories

Please refer to the appropriate accessory installation sheet for further instruction when applicable.

Wiring Box 19 538

Replacement Parts

Description	Part No
Face Plate	FP6972
LED driver (120V-277V)	76023
LED replacement (3000K)	LED-0488/930
LED replacement (4000K)	LED-0488/940

Lamp: 3W LED

In the interest of product improvement, BEGA reserves the right to make technical changes without notice.

Product Safety Warnings:

THIS PRODUCT MUST BE INSTALLED IN ACCORDANCE WITH THE APPLICABLE INSTALLATION CODE BY A PERSON FAMILIAR WITH THE CONSTRUCTION AND OPERATION OF THE PRODUCT AND THE HAZARDS INVOLVED. SUITABLE FOR WET LOCATIONS.

MIN 90°C SUPPLY CONDUCTORS.

CE PRODUIT DOIT ÊTRE INSTALLÉ SELON LE CODE D'INSTALLATION PERTINENT, PAR UNE PERSONNE QUI CONNAÎT BIEN LE PRODUIT ET SON FONCTIONNEMENT AINSI QUE LES RISQUES INHÉRENTS. CONVIENT AUX EMPLACEMENTS MOUILLÉS.

LES FILS D'ALIMENTATION 90°C MIN.
