

Tools Required:

- T10 Torx screwdriver
- 4mm Hex wrench

Overview:

LED Watts: 67.2W
 System Watts: 83.0W
 Controllability: 0-10V dimmable down to 0.1%
 Weight: 32 lbs.

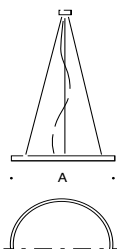

Dimensions

A: 19-5/8"

B: 1-5/8"

C: 158"



Notice to Installer:

1. See page 2 for specific product safety warnings.
2. Mounts directly over standard recessed 4" octagonal wiring box (by others).
3. LEDs are high-quality electronic components! Please avoid touching the light output opening of the LED directly during installation.

Installation:

1. Disconnect mounting plate from canopy by disengaging magnetic connection and removing canopy screw using 4mm hex wrench. [Figure 1]
2. Steel safety wire fixed to the back of the mounting plate must be firmly secured to suitable structural building component. [Figure 1]
3. Lead mains supply cable into 4" octagonal wiring box.
4. Make connections from luminaire electrical cable to supply wiring:
 MAIN VOLTAGE SUPPLY WIRE TO BLACK DRIVER WIRE(S);
 NEUTRAL (COMMON SUPPLY WIRE TO WHITE DRIVER WIRE(S);
 GREEN GROUND WIRE TO GREEN DRIVER WIRE(S).
 Dimming (if applicable):
 DIMMING CONTROL WIRE (+) TO POSITIVE DRIVER DIM CONTROL WIRE
 DIMMING CONTROL WIRE (-) TO NEGATIVE DRIVER DIM CONTROL WIRE
5. Attach mounting plate onto ceiling, mounting over 4" octagonal wiring box.
6. Unpack the luminaire and place it on a soft surface.
ATTENTION! It is imperative to feed the ball shaped hook through the cut-out of the mounting plate [Figure 2]
7. Relieve the strain on the luminaire power cable by using a T10 Torx screwdriver, loosen the strain relief screws on both steel couplers. [Figure 3]
8. Secure cable by tightening both steel couplers and screws. [Figure 3]
9. Push the canopy up to the ceiling until recesses match with steel wires and magnets engage and tighten the canopy screw using 4mm hex wrench.

Installation: Luminaire - Cable Shortening (as needed)

1. Support cables must be shortened on pendant side only. Cut luminaire electrical wire as needed.
2. Electrical cabling must be shortened on the canopy side.
3. Shut off power to luminaire.
4. Feed steel wiring into nozzle of grip lock connector located on the pendant to reduce length of steel wire as required. [Figure 4]
5. Depress the nozzle of the ball shaped wire catch located on the pendant to add length of steel wire as required. [Figure 6]
6. Carry out fine adjustment at the steel wire catch.
7. Lower the luminaire carefully into its suspended position.
8. If steel cable needs to be cut, the end will need to be soldered in order to be reinserted into grip-lock connector.
CAUTION! The luminaire may only be placed under load when it is static.
The steel wires are unsuitable for any type of moving dynamic loads!

WARNING:

FAILURE TO FOLLOW THESE INSTALLATION INSTRUCTIONS CAN CAUSE FIXTURE TO FAIL. DO NOT TAMPER WITH SAFETY HARDWARE ON FIXTURE SIDE.

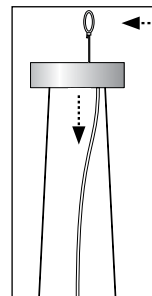

Figure 1: Canopy Cover Removal

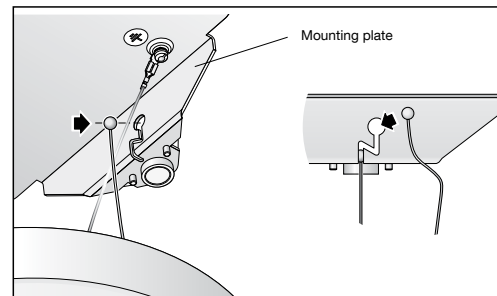

Figure 2: Ball Shaped Hook

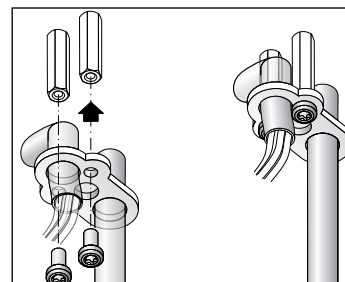

Figure 3: Support Hook

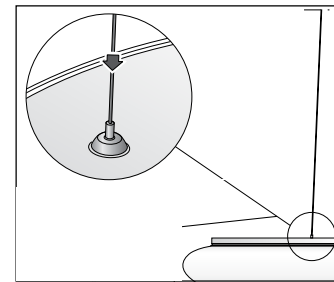

Figure 4: Cable Shortening

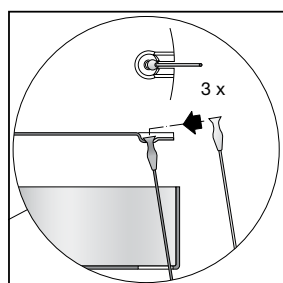

Figure 5: Cable Hook

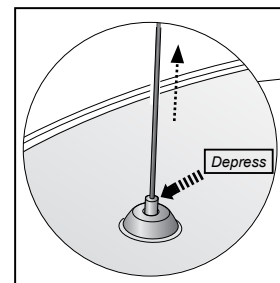

Figure 6: Cable Extension

Accessories

Please refer to the appropriate accessory installation sheet for further instruction when applicable.

Maintenance:

Clean regularly with solvent-free cleaner removing dirt and debris. Do not use high pressure cleaners.

Replacement Parts

See label inside of fixture for LED replacement part number.

Consult factory for all other replacement components.

Product Safety Warnings:

THIS PRODUCT MUST BE INSTALLED IN ACCORDANCE WITH THE APPLICABLE INSTALLATION CODE BY A PERSON FAMILIAR WITH THE CONSTRUCTION AND OPERATION OF THE PRODUCT AND THE HAZARDS INVOLVED. SUITABLE FOR DAMP LOCATIONS. MIN 90°C SUPPLY CONDUCTORS.

CE PRODUIT DOIT ÊTRE INSTALLÉ SELON LE CODE D'INSTALLATION PERTINENT, PAR UNE PERSONNE QUI CONNAÎT BIEN LE PRODUIT ET SON FONCTIONNEMENT AINSI QUE LES RISQUES INHÉRENTS. CONVIENT AUX EMPLACEMENTS HUMIDE.

LES FILS D'ALIMENTATION 90°C MIN.