

**Tools Required:**

- Phillips medium screwdriver
- Standard medium screwdriver
- 3mm hex head

**Dimensions**

- A: 41 3/8"
- B: 2"
- C: 3-1/8"



**Weight:** 5.95 lbs.



**Notice to Installer for 50 142:**

1. Rated for damp locations - for interior applications only.
2. Luminaire mounting canopy mounts directly to finished surface over BEGA recessed wiring box 19 537.
3. LEDs are high quality electronic components! Please avoid touching the light output opening of the LED directly during installation.

**19 537 - wiring box installation:**

1. **Hollow (stud) wall construction** - Secure wiring box to wood or metal vertical blocking. Connect conduit to wiring box (if needed) and pull wires for electrical connections to be made later.
2. **Poured concrete construction** - Attach wiring box to the concrete form. Connect conduit to wiring box (if needed) and pull wires for electrical connections to be made later. Pour concrete and remove form.

**IMPORTANT: Do not pour concrete directly on to box!**

**50 142 installation:**

1. Undo hex screw on side of luminaire cap to remove glass.
2. Route wires through luminaire base.
3. Make supply wiring and luminaire wiring connections inside wiring box:  
 MAIN VOLTAGE SUPPLY WIRE TO BLACK LUMINAIRE WIRE  
 NEUTRAL (COMMON) SUPPLY WIRE TO WHITE LUMINAIRE WIRE  
 GREEN GROUND WIRE TO GREEN LUMINAIRE WIRE
- Dimming (if applicable):  
 DIMMING CONTROL WIRE (+) TO POSITIVE DRIVER DIM CONTROL WIRE  
 DIMMING CONTROL WIRE (-) TO NEGATIVE DRIVER DIM CONTROL WIRE
4. Attach luminaire base to finished surface using appropriate hardware (by others)
5. Carefully replace glass and fix hex screw to secure.

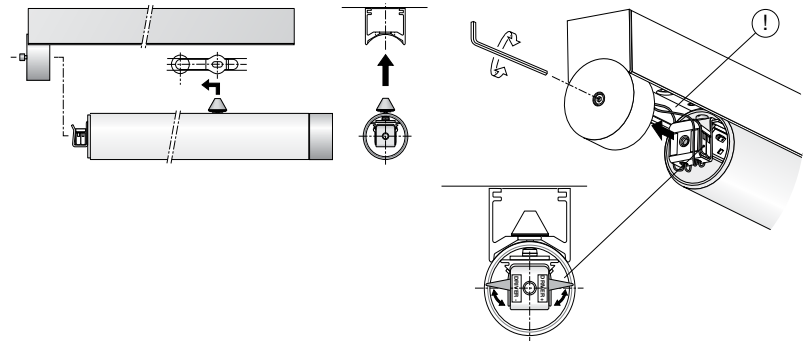
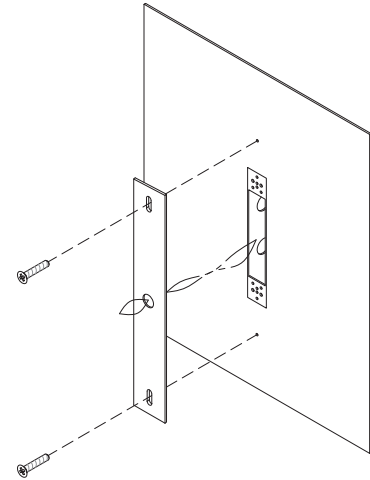

**Relamping/Maintenance**

Clean dirt and deposits from the luminaire and glass using only solvent-free cleaners. Relamp.

**Accessories**

Please refer to the appropriate accessory installation sheet for further instruction when applicable.

**Replacement Parts**

Description	Part No
LED Module (3000K)	LED-0694/930
LED Module (4000K)	LED-0694/940
Driver (120V-277V)	75969-04
Diffuser	150482

**Lamp:** 35.2W LED

Wiring Box 19 537

In the interest of product improvement, BEGA reserves the right to make technical changes without notice.

**Product Safety Warnings:**

**THIS PRODUCT MUST BE INSTALLED IN ACCORDANCE WITH THE APPLICABLE INSTALLATION CODE BY A PERSON FAMILIAR WITH THE CONSTRUCTION AND OPERATION OF THE PRODUCT AND THE HAZARDS INVOLVED. SUITABLE FOR DAMP LOCATIONS.**

**MIN 90°C SUPPLY CONDUCTORS.**

**CE PRODUIT DOIT ÊTRE INSTALLÉ SELON LE CODE D'INSTALLATION PERTINENT, PAR UNE PERSONNE QUI CONNAÎT BIEN LE PRODUIT ET SON FONCTIONNEMENT AINSI QUE LES RISQUES INHÉRENTS. CONVIENT AUX EMBLEMES HUMIDES.**

**LES FILS D'ALIMENTATION 90°C MIN.**