

Tools Required:

- Phillips medium screwdriver
- 2.5mm hex screwdriver

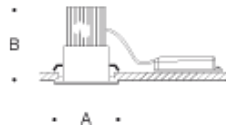

Dimensions

A: 3-1/8 "

B: 4-1/2 "



**Notice: Instructions for standard installation.
For options, see pages 2-3.**

Notice to Installer for 34 984:

1. See page 4 for specific product safety warnings.
2. Select the desired trim ring or housing material finish by using appropriate code number as suffix.
 - Code number .1 - White
 - Code number .2 - Stainless steel
 - Code number .3 - Polished stainless steel
 - Code number .4 - Brass
3. Luminaire is non-IC rated. Insulation must be at least 3" from luminaire.
4. Luminaire not suitable for poured concrete construction.
5. Minimum ceiling clearance is 7" to fit ceiling box. Minimum ceiling thickness 1/8", maximum ceiling thickness is 3/4".
6. CEILINGBOX provided.
7. Ceiling cut out is 2-11/16"
8. Integral LED module and ceiling box with LED Driver included (**Figure 1**).
9. LEDs are high-quality electronic components! Please avoid touching the light output opening of the LED directly during installation.
10. See pages 2 and 3 for IC housing, CCEA housing and ceiling pan installation instructions.

CEILINGBOX-S-TRP350 Instructions:

1. Fixture is connected to wiring box via quick-disconnect. Disconnect fixture and ceilingbox.
2. Unscrew (2) 3mm hex head screws to open ceiling box.
3. Bring supply wiring into ceiling box via strain relief bushing and make connections from supply wires to driver wires:
 - MAIN VOLTAGE SUPPLY WIRE TO BLACK BALLAST WIRE(S);
 - NEUTRAL (COMMON SUPPLY WIRE TO WHITE BALLAST WIRE(S);
 - GREEN GROUND WIRE TO GREEN BALLAST WIRE(S).

Dimming (if applicable):

- DIMMING CONTROL WIRE (+) TO POSITIVE DRIVER DIM CONTROL WIRE
 - DIMMING CONTROL WIRE (-) TO NEGATIVE DRIVER DIM CONTROL WIRE
4. Tighten (2) Philips-head screws on strain relief bushing. Replace and tighten (2) 3mm hex head screws to close ceiling box. Connect the fixture to the ceilingbox via quick-disconnect.
 5. Push the ceiling box through the ceiling cut-out. The ceiling box will rest on ceiling panels or other ceiling construction material.

Note: Minimum ceiling clearance of 7" is required to fit ceiling box.

34 984 Installation Instructions:

1. Carefully unscrew glass diffuser.
2. Ensure fixture is attached to ceiling box via quick-disconnect.
3. Attach safety wire from luminaire to ceiling box by tightening (1) Philips-head screw into

Figure 1

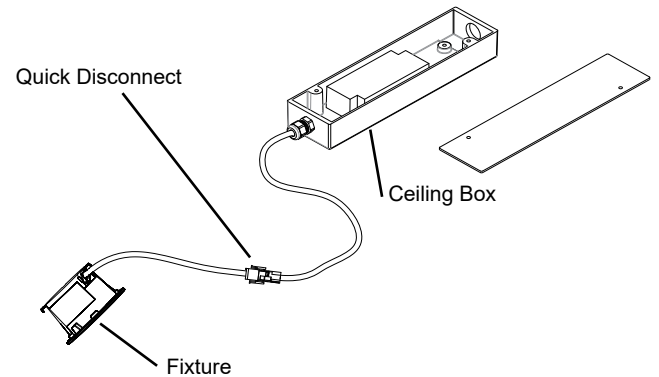
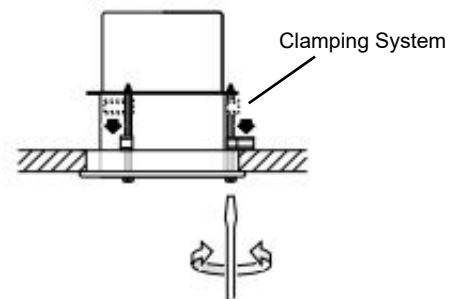

Figure 2



Relamping/Maintenance

No relamping required.

Accessories

Please refer to the appropriate accessory installation sheet for further instruction when applicable.

Replacement Parts

Description	Part No
Driver (120-277V)	75990
LED (3000K)	LED-0423/930
LED (4000K)	LED-0423/940

Lamp: 12.5W LED

Ceiling Box	CEILINGBOX-S-TRP350
IC Housing	19510
CCEA rated IC Housing	19511
Ceiling Pan	19516

In the interest of product improvement, BEGA reserves the right to make technical changes without notice.

Rough-in kit 19510 / 19511
for use with Recessed Ceiling Luminaires:
34 984.X, 34 985.X

Tools Required:
Phillips medium screwdriver

Notice: Instructions for IC housing option OR CCEA IC housing option.

Notice to Installer for 19510 / 19511:

- Luminaire suitable for new ceiling stud construction or suspended ceilings (T-bar type). Luminaire not suitable for poured concrete construction.
- Fasteners to attach to T-bar system (Caddy Fasteners #ATS41) included.
- Minimum ceiling clearance is 4-3/4".
- Ceiling cut out is 2-11/16".
- Integral LED module and mounted LED Driver included.
- IC box must be accessible from above during wiring installation.

Rough-in kit installation:

- For ceiling stud construction: Position rough-in kit in ceiling so bottom of box will sit on top of ceiling material. Adjust bar hanger wires if needed. Nail conduit brackets to available ceiling structure.
- For suspended ceiling construction: Conduit brackets can be directly attached to (4) Caddy Fasteners #ATS41 for attachment to T-bar. Attach brackets to fasteners, and then attach to T-bar. Level rough-in kit so bottom of box will sit on top of ceiling material.

- Pull off ceiling box cover.
- Bring supply wiring in to IC box and make connections from supply wires to driver connector:
MAIN VOLTAGE SUPPLY WIRE TO BLACK DRIVER TERMINAL
NEUTRAL (COMMON) SUPPLY WIRE TO WHITE DRIVER TERMINAL
GREEN GROUND WIRE TO GREEN DRIVER TERMINAL

- Dimming (if applicable):**
DIMMING CONTROL WIRE (+) TO POSITIVE DRIVER DIM CONTROL WIRE
DIMMING CONTROL WIRE (-) TO NEGATIVE DRIVER DIM CONTROL WIRE

- Replace IC box cover and tighten using (4) wing-nuts (provided).
- Finish ceiling. Ceiling cut out is 2-11/16".

Fixture Installation:

NOTE: See individual fixture installation instructions for specific product safety warnings and notices.

- Carefully unscrew glass diffuser
- Ensure fixture is attached to IC box via quick disconnect.
- Place luminaire housing up into ceiling and tighten (2) 2.5mm hex-head screws to engage clamping system to attach and secure luminaire housing ceiling.
- Ensure trim ring is positioned correctly. Replace glass diffuser. Do not over-tighten.

Maintenance:

- Carefully unscrew glass diffuser.
- Unscrew (2) 2.5mm hex-head screws to loosen clamping system.
- Tilt luminaire and remove through ceiling cutout. Disconnect from driver via quick-disconnect.
- To access driver, loosen thumb screw to release bracket and driver. Pull bracket and driver out through ceiling cutout.

Figure 1

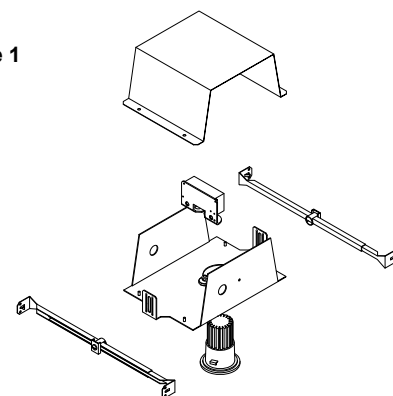

Figure 2: Top View

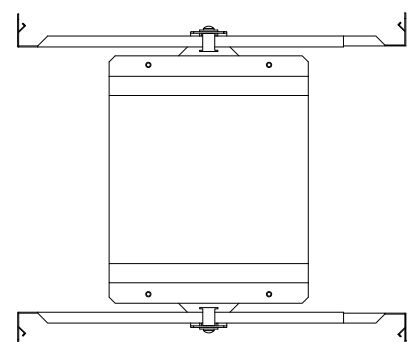
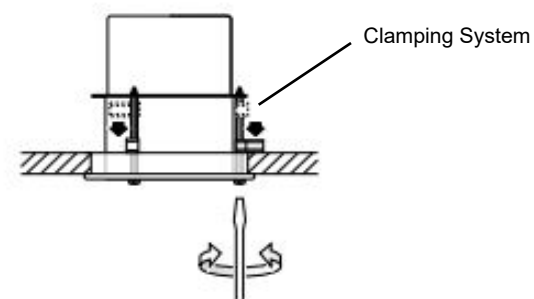

Figure 3 (Generic Image)



Rough-in kit 19516
for use with Recessed Ceiling Luminaires:
34 984.X, 34 985.X, 34 874.X, 34 554.X, 34 290.X, 23 225.X,
34 869.X, 34 552.X, 34 289.X, 23 224.X, 23 806.X, 23 845.X,
23 579.X, 23 580.X, 23 558.X, 23 568.X, 23 226.X, 23 228.X

Tools Required:
Phillips medium screwdriver

Notice: Instructions for ceiling pan option.

Notice to Installer for 19516:

- Luminaire's are non-IC rated; insulation must be at least 3" from luminaire.
- Suitable for installation in covered ceilings only. Recommended for suspended ceilings.
- Luminaire suitable for new ceiling stud construction (bar hanger type) or suspended ceilings (T-bar type). Luminaire not suitable for poured concrete construction.
- T-bar system (Caddy Fasteners #ATS41) included.
- Minimum ceiling clearance is 4-1/2".
- Ceiling cut out is 2-11/16".
- Mounted LED Driver included.

NOTE: Electrician MUST have access to ceiling pan from above for installation and maintenance.

Rough-in kit installation:

- For ceiling stud construction: Position rough-in kit in ceiling so bottom of pan will sit on top of ceiling material. Adjust bar hanger brackets if needed. Nail conduit brackets to available ceiling structure.
- For suspended ceiling construction: Conduit brackets can be directly attached to (4) Caddy Fasteners #ATS41 for attachment to T-bar. Attach brackets to fasteners, and then attach to T-bar. Level rough-in kit so bottom of box will sit on top of ceiling material.

- Bring supply wiring in to junction box and make connections from supply wires to driver wires:
MAIN VOLTAGE SUPPLY WIRE TO BLACK DRIVER WIRE(S);
NEUTRAL (COMMON SUPPLY WIRE TO WHITE DRIVER WIRE(S);
GREEN GROUND WIRE TO GREEN DRIVER WIRE(S).

- Dimming (if applicable):**
DIMMING CONTROL WIRE (+) TO POSITIVE DRIVER DIM CONTROL WIRE
DIMMING CONTROL WIRE (-) TO NEGATIVE DRIVER DIM CONTROL WIRE

- Finish ceiling. Ceiling cut out is 2-11/16".

Fixture Installation:

NOTE: See individual fixture installation instructions for specific product safety warnings and notices.

- Carefully unscrew glass diffuser
- Ensure fixture is attached to ceiling pan via quick disconnect.
- Place luminaire housing up into ceiling and tighten (2) 2.5mm hex-head screws to engage clamping system to attach and secure luminaire housing ceiling.
- Ensure trim ring is positioned correctly. Replace glass diffuser. Do not over-tighten.

Maintenance:

- Carefully unscrew glass diffuser.
- Unscrew (2) 2.5mm hex-head screws to loosen clamping system.
- Tilt luminaire and remove through ceiling cutout. Disconnect from driver via quick-disconnect.
- To access driver, pan must be accessible from above the finished ceiling.

Figure 1

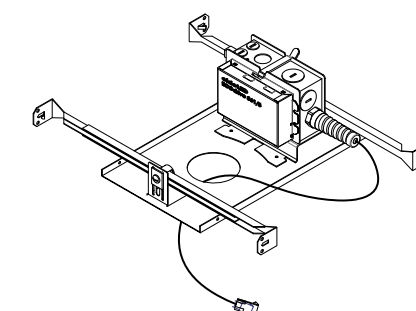

Figure 2

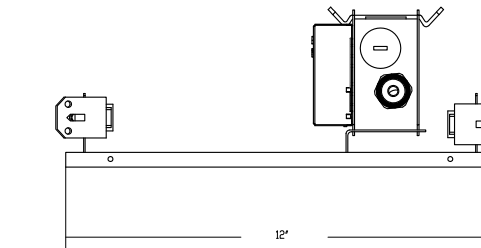
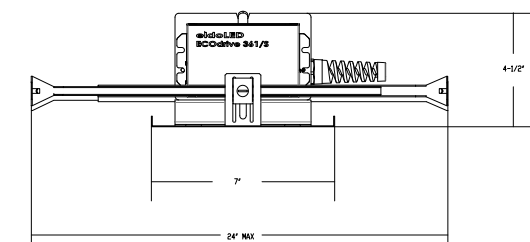
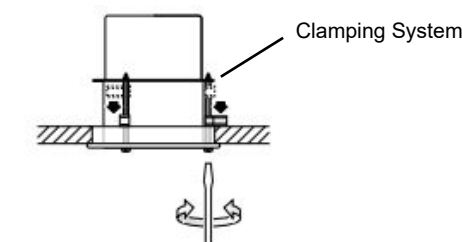

Figure 3 (Generic Image)



Product Safety Warnings:

THIS PRODUCT MUST BE INSTALLED IN ACCORDANCE WITH THE APPLICABLE INSTALLATION CODE BY A PERSON FAMILIAR WITH THE CONSTRUCTION AND OPERATION OF THE PRODUCT AND THE HAZARDS INVOLVED. SUITABLE FOR DAMP LOCATIONS.

MIN 90°C SUPPLY CONDUCTORS.

CE PRODUIT DOIT ÊTRE INSTALLÉ SELON LE CODE D'INSTALLATION PERTINENT, PAR UNE PERSONNE QUI CONNAÎT BIEN LE PRODUIT ET SON FONCTIONNEMENT AINSI QUE LES RISQUES INHÉRENTS. CONVIENT AUX EMPLACEMENTS HUMIDES.

LES FILS D'ALIMENTATION 90°C MIN.
